



First in Quality. Built to Last.

EASY PACKER

CASE TAPING SYSTEM

OPERATOR FRIENDLY

The side belt driven Easy Packer is designed for compact, packing and sealing. The durable design has proven to be one of the most reliable case tapers on the market today, keeping production and maintenance efforts to a minimum. The Easy Packer provides a fast and cost-efficient alternative to hand taping.

PACKING AND SEALING MADE EASY

Designed with the customer in mind, the Easy Packer is supplied with extended side rails, flap closing bars, and an optional 48" anvil packing station to assist with the packing and sealing process. Operation is simple: open the case and manually fold the bottom front and back minor flaps and place case on the anvil to be filled. Once filled, the operator pushes down and holds the top trailing minor flap while the box enters the machine to be sealed.

Users can also order the Easy Packer without the anvil for use with an Easteys EX-CF Carton Former. The EX-CF Carton Former automatically folds the bottom major and minor flaps and holds the box in place for the operator to fill. Filled cases can then be pushed into the Easy Packer for automated top and bottom case-sealing.

COMPACT CASE ERECTING, PACKING AND SEALING

Designed to streamline manual case packing, the Easy Packer can be ordered with or without an anvil pack station, extended side rails, and flap closing bars to assist with the packing and sealing process.

LESS DOWNTIME

Easy Packer offers fast and easy case changes with adjustable side rails and flexibility for boxes 5" in length and greater. Adjustments can be made on the fly with easy hand tighten knobs and cranks. Easy Packer utilizes Easteys Easy-Taper Quick-Load top and bottom tape cartridges and will seal boxes as narrow as 4.0" wide and as low as 4.0" tall.

INDUSTRIAL QUALITY

CE approved dual drive motors, aggressive industrial strength side belts and roller tables make Easy Packer a workhorse. Each machine is made from 12 gauge steel and will withstand the most rugged applications. The powder coated exterior protects the machine from abusive conditions and guarantees years of use.

CONVENIENCE

These machines accept 2" wide pressure-sensitive tape as a standard, or can be ordered with 3" tape heads. The use of Easteys Easy Packer case taping machine can be learned in minutes, avoiding breaks in production and downtime, saving your company money and increasing your ROI.

THE RIGHT SOLUTION

Rugged design. Proven reliability. Simple operation. Your benefits go on and on. When it comes to industrial operation, rely on Easteys to provide the right solution for your case sealing needs.

EASY PACKER CASE TAPING SYSTEM



*The Easy Packer is also available without the anvil packing station for use with Easteys's EX-CF Carton Former

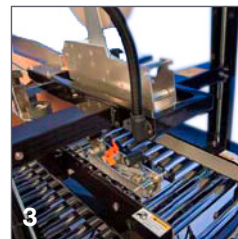
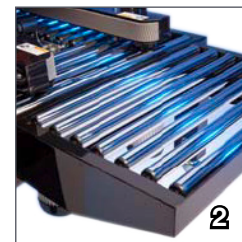
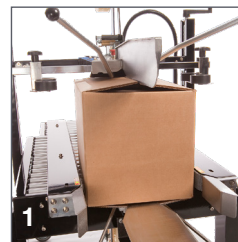
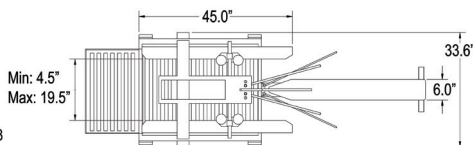
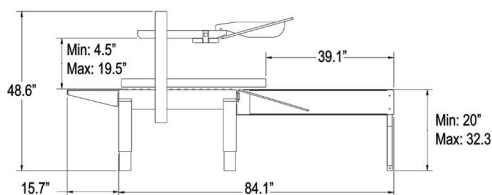

1. Flap closing bars plow and assist in flap closing prior to being sealed
2. Industrial strength roller beds move boxes consistently through the taper
3. Adjustable side rails and tape head offer fast and easy case changes
4. Top and bottom tapeheads are identical and can be removed instantly without tools. Choose from two options.

EASY PACKER FEATURES	EASY PACKER TAPING SPECIFICATIONS				
<ul style="list-style-type: none"> Available with anvil packing station for easy case packing, or available without anvil packing station to be used with Easteys's EX-CF Carton Former Utilizes Easteys's Easy-Taper tapehead Plug-in and go operation Powder coated 12 gauge steel Top and bottom tape cartridges Industrial strength side belts Adjustable leg extensions Fast and easy box size changes Low maintenance Accommodates wide case range Casters for transportation within plant 	Sealer Type	Uniform side belt, top and bottom case sealer			
	Machinery Makeup	Industrial strength 12 gauge steel, powder coated for durability			
	Belt Speed	75 feet/per minute			
	Tape Speed	20 cases/per minute, depending on box size and operator efficiency			
	Height Adjustment	Standard adjustable legs for 20" to 32.3" conveyor heights			
	BOX SPECIFICATIONS		Length	Width	Depth
	Minimum Box Size	5"	4.0"	4.0"	
	Maximum Box Size	Infinite	19.5"	19.5"	
	Tape Size	2" wide pressure sensitive tape, up to 15" diameter rolls, optional 3" wide tape			
	Tape Cartridge	Proven design requires no lubrication, designed for simple tape threading, removable for maintenance and interchangeable with top or bottom cartridges			
Air Requirements	None				
Electrical Requirements	110 VAC, 60Hz, 4.0A				
Agency Approvals	CE Certification				
EASY PACKER OPTIONAL ACCESSORIES					
3" Tape Head	Accepts 3" wide tape rolls				
Front Packing Table	Roller table bolts before taping system to allow for case movement; replaces anvil packing station				
Rear Packing Table	Roller table bolts after taping system to allow for case movement				